



# Your Legacy, Our Canvas

*Shape the future of the*

**FRANCES M.  
MAGUIRE  
ART MUSEUM**





## The Frances M. Maguire Art Museum stands apart from other institutions in Philadelphia's prestigious art world.

Housed in the former home of the world-renowned Barnes Foundation, the Frances M. Maguire Art Museum (FMAM) preserves and transforms the architecture and design of the space while expanding upon its repertoire – offering media and performances that extend far beyond the fine arts. The Museum pays homage to the rich history and unique architecture of the building while simultaneously modernizing the experience for art admirers within its galleries.

Located on Saint Joseph's University's campus, [the Museum opened in May 2023 with a mission of celebrating the power of art and its ability to inspire imagination and curiosity.](#) Immediately, the Museum set out to cultivate creative thinking and dialogue within its community of students, employees, alumni and the general public by engaging in rotating exhibitions, educational programming and events focused on the University's fabulous permanent collection. In this way, the Museum has become a unifying space within the community where students, faculty and neighbors can come together to learn and connect.

Because of this, the FMAM has added an entirely new dimension to the University and plays an integral role in Saint Joseph's vision and success.



At the Museum, students and community members alike are able to access and appreciate priceless and renowned works of art. They are invited to go deeper through the myriad offerings and programs to discover the benefits art provides. This immersive experience with art is an extension of SJU's educational philosophy that develops all facets of students– the intellectual, the spiritual and the creative.

Since its opening, the Museum has launched flagship annual events to celebrate a diversity of cultures and backgrounds. There have been exhibitions that showcase the talents of underrepresented groups, local high school students and artists working with unconventional media. Every day, the Museum enables SJU students to experience new and innovative ways of learning their subject matter, whether they are majoring in Decision and Systems Sciences, Environmental Sustainability or Fine Arts.

The FMAM is an institution like no other. It is a hub that promotes exploration, critical thinking and emotional well-being through art. It is a place where students, faculty, staff and neighbors can learn, build community and become inspired. Best of all – it's free of charge. No one ever has to pay an entry fee to take advantage of what the FMAM has to offer.

As the University looks to expand Museum programming, it is seeking endowment support, which is critical to growing the Museum's expansive collection, maintaining and strengthening its ambitious educational initiatives and securing its position as a cultural hub for the University and its broader community.







PRIORITY ONE:

# An Interdisciplinary Art Experience

**At Saint Joseph's, students are encouraged to explore and develop all facets of themselves – the intellectual, the spiritual and the creative.**

Accordingly, over 900 St. Joe's students attend classes in the Museum each month, making use of the thoughtfully designed classrooms and galleries. The spaces are used to expand students' horizons, and ways of thinking and learning.

Providing interdisciplinary experiences is a hallmark of a St. Joe's education and the FMAM offers incredible programming and spaces that support interdisciplinary education.

It takes intentionality, vision and a spirit of collaboration to bring these interdisciplinary experiences to life. The Museum Director identifies opportunities for enrichment within Saint Joseph's academic curricula, ensuring our students' learning experiences are fostered and enhanced using programming, exhibitions and gallery spaces in the Museum.

For example, faculty across all disciplines take advantage of the Museum by bringing students to experience art and learn translatable skills like observation and empathy through creative expression. Students studying to pursue a career in the multitudinous fields of art have access to critique space, a conservation lab and a teaching gallery where they can explore curriculums and practice their craft.

“As a student at SJU, the FMAM has become a cornerstone of my experience. It offers an environment that invites you to explore the creativity of both renowned artists and our own students. Whether your path is as an artist or working behind the scenes, the Museum provides an encouraging atmosphere for all who enter.”

- Brianna Kelly '26



## PRIORITY ONE: AN INTERDISCIPLINARY ART EXPERIENCE

Beyond fine arts disciplines, the Museum's two modern art galleries have been host to multiple research cohorts from the Haub School of Business who are studying AI implications in art cataloging. Decisions and Systems Sciences majors even used the gallery spaces to program SJU's robot, Iggy, to be a docent and answer questions about the exhibitions.

Saint Joseph's occupational therapy students have also worked through all the Museum galleries as part of a capstone project to identify areas where accessibility can be improved within the facility.



## SOAR WITH US

Endow the **Museum Director position** to drive long-term leadership and strategy on making the Museum a foundational part of an SJU student's education.

**Name a space** in the Frances M. Maguire Art Museum. Leave a lasting legacy while providing essential financial support for an endowment that contributes to our operating costs. This will ensure the sustainability of the Museum's operations for generations to come, enriching the University's educational mission and adding an exciting new dimension to our campus.







PRIORITY TWO:

# Conserve and Expand the Collection

The Frances M. Maguire Art Museum’s permanent collection consists of over 2,500 artworks spanning nearly 3,000 years from North and South America, Europe, Africa and Asia.

This collection is considered particularly exceptional for its extensive Colonial Latin American art, which includes paintings, sculptures, textiles and decorative artworks from Mexico, the Andean region, and the Philippines.

As stewards of this impressive collection, it is the Museum’s responsibility to ensure its longevity and preserve its cultural heritage for future generations. Conserving the pieces in the collection and expanding its repertoire bolsters the Museum’s contribution to important discussions about art history and museum practices, including questions about provenance, collecting and authenticity.

With your support, the Museum can acquire new works of art with a focus on contemporary, complementary pieces.

“

[The collection] is a wonderful blend of rich items from many sources, reflected in such an historic and hallowed venue, the products and inspirations of both the University, the Barnes history, and the art of numerous times and cultures.”

- Nancy Porter, Museum visitor

## SOAR WITH US

Endow a **Curator position** to support research and acquisitions for the Museum collection and ensure high-quality exhibitions. This position will work in partnership with educational programs and community engagement, ensuring the Museum’s long-term growth and impact.

An **Acquisitions Endowment** will support the intentional growth of the Frances M. Maguire Art Museum’s collections, strengthening its breadth and diversity.





PRIORITY THREE:

# Excellence in Exhibitions and Programming

In its first year of operation, the Museum has organized 10 interdisciplinary exhibitions – all of which involved the direct participation of University students. There were eight lectures and artist talks, and more than 50 special events focused on elevating underrepresented voices.

These exhibitions introduce audiences to a wide range of artistic perspectives, styles and cultural contexts that complement the Museum’s own collection. These events facilitate critical conversations and dialogue within the community and promote wellness. Hosting traveling exhibitions also enables the Museum to foster partnerships with other institutions and artists.

Financial support is crucial in securing the high-quality rotating exhibitions that broaden the scope of the Museum’s offerings. Installations, logistics and educational programming to contextualize these external works are just a few of the expenses that make this programming so impactful. An investment in the Museum’s exhibitions and programming will maintain the FMAM’s relevance, attract a broad range of audiences and support its mission of cultural and educational enrichment.

“

I was fortunate to see the Ella Fontanels Cisneros Exhibition at the FMAM. It was a pleasant surprise to see a Latin American collection of abstract art in such a beautiful environment. I love that the Museum is interested in bringing artistic expressions from different parts of the world.”

- Raúl García Zentlapal, Deputy Consul,  
Consulate of Mexico in Philadelphia

## SOAR WITH US

A **Rotating Exhibitions Fund** will support the Museum’s ability to introduce fresh, diverse and dynamic exhibitions on a regular basis. This fund will keep the Museum experience vibrant and engaging for new and repeat visitors from the region and across the country.





PRIORITY FOUR:

# Arts Education for K-12 Students

The Frances M. Maguire Art Museum was founded with a goal of providing art education for the broader community.

Today, the Museum provides K-12 students direct access to original works of art, fostering an immersive learning experience that takes them far beyond the classroom. By engaging with artworks, students develop critical thinking and visual literacy skills, learn to appreciate different cultural perspectives, and gain insights into historical and contemporary contexts.

The Museum also offers interactive programs, workshops and guided tours tailored to various age groups with the goal of enhancing students' understanding and appreciation of art and themselves.

Investing in these experiences for children inspires creativity, self-expression and a lifelong love for the arts, contributing significantly to K-12 students' overall cognitive and emotional development.

“

I just wanted to thank you again for the amazing exhibition that happened last week. I'm still in awe and the parents and family members are still talking about it. The students are returning to school with an 'I can do anything' mentality and a special swag to their walk!”

- Ron Toles, Founder and Executive  
Director of OrdinarIE Heroes

## SOAR WITH US

An **Outreach and Education Fund** will support innovative K-12 programming with Greater Philadelphia Area schools.

Endow the **Director of Education and Community Engagement** position.





PRIORITY FIVE:

# Securing the Museum as a Cultural Hub

In keeping with the founding sentiment of the Barnes Foundation; it is the firm belief of the Frances M. Maguire Art Museum and Saint Joseph's University that art is not an esoteric luxury reserved for the privileged. Art is for and about everyone, and everything; that is why the University is dedicated to keeping this space free to the public.

The Museum features a dynamic program of engaging exhibitions and events that nurture a genuine exchange of ideas, research and discussions. The Museum has rapidly become a pillar in the community of both West Philadelphia and Lower Merion, where local residents see the Museum as the cultural centerpiece of their communities.

## SOAR WITH US

Endow a **Director of Education and Community Engagement position** to enhance and expand our educational programs and outreach.

Fund an **Annual Lecture Series** to foster dialogue between experts and the public to enhance community connections and spread art education. This will position the Frances M. Maguire Art Museum as a hub for lifelong learning and will attract diverse audiences.

“

This summer we hosted Camp Ginkgo at the Maguire Museum, which was a truly enriching experience, blending art and nature in a magical setting. The combination of the Museum's resources and the beautiful surroundings made for a memorable summer for all of us.”

- Jerry Puryear,  
Program Manager, Camp Ginkgo,  
West Park Cultural Center



# Legacy at the Ground Level

The Frances M. Maguire Art Museum has brought a new dimension to our community, one of world-class excellence and limitless potential. It has already developed an impressive list of accomplishments and accolades — but this is only the beginning. We have visions for much more. You can make that happen.

As a noted patron of the arts, you have before you an opportunity as unique and impactful as the Museum itself. Your support can lay the groundwork for a future of community-changing art and education experiences.

We are seeking individuals who believe deeply in using art as a bridge between community members, who see limitless value in art as a tool for wellness and experiential learning, and as

a mechanism for educating people of all ages about history, culture, and expression.

The Museum has shown its incredible impact after just one year of operation. We now look to you as educators, community members and believers in the power of art to ensure that this impact continues in perpetuity.

**We are asking for your support in funding at least a \$12 million endowment for the Frances M. Maguire Art Museum.**





# The Power of an Endowment

Operating a world-class arts institution and a pivotal asset of the local community is not easy or inexpensive. Your support of this seminal endowment fund will make you a foundational investor in the provision of the Frances M. Maguire Art Museum's services for years to come.

Educational programming, gallery spaces, the maintenance of priceless collections and salaries for full-time positions are all integral pieces of the Museum that will be funded through your generosity.

With multiple key areas of operation benefiting from this fund, you, as a donor, are able to direct your gift to a chosen area of need while benefiting the endowment as a whole.





# Naming Opportunities

<b>106</b>	Gallery, Rotating Exhibitions #1	First Floor	\$250,000
<b>107</b>	Gallery, Rotating Exhibitions #2	First Floor	\$100,000
<b>109</b>	Gallery <i>Currently Spanish Colonial Art #1</i>	First Floor	\$500,000
<b>110</b>	Grand Hall	First Floor	\$1,000,000
<b>111</b>	Gallery <i>Currently Spanish Colonial Art #2</i>	First Floor	\$500,000
<b>112</b>	Gallery <i>Currently retablos and ex votos</i>	First Floor	\$100,000
<b>113</b>	Gallery <i>Currently African Art</i>	First Floor	\$100,000
<b>114</b>	Gallery, Rotating Exhibitions #3	First Floor	\$100,000
<b>115</b>	Gallery, Rotating Exhibitions #4	First Floor	\$250,000
<b>201</b>	Conference Room	Second Floor	\$100,000
<b>202</b>	Corridor/Exhibition Space	Second Floor	\$100,000
<b>203</b>	Gallery, Plaster Casts	Second Floor	\$250,000
<b>204</b>	Teaching Gallery	Second Floor	\$100,000
<b>205</b>	Critique & Lab Exhibition Space	Second Floor	\$100,000
<b>208</b>	Gallery, Stained glass	Second Floor	\$250,000
<b>212</b>	Gallery <i>Currently 20th-c. American &amp; European Art</i>	Second Floor	\$500,000
<b>213</b>	Gallery <i>Currently Saint Joseph's University History</i>	Second Floor	\$100,000
<b>214</b>	Gallery <i>Currently Wernersville Art</i>	Second Floor	\$250,000
<b>215</b>	Seminar Room	Second Floor	\$50,000
<b>008</b>	Museum Shop	Lower Level	\$100,000
<b>010</b>	Conservation Lab	Lower Level	\$100,000

## First Floor

- Lobby  
Rotating Exhibitions  
Rotating Exhibitions  
Colonial Andean Art  
Great Hall  
Colonial Mexican Art  
Retablos and Ex Votos  
African Art  
Architectural History  
Rotating Exhibitions
- 102  
106  
107  
109  
110  
111  
112  
113  
114  
115

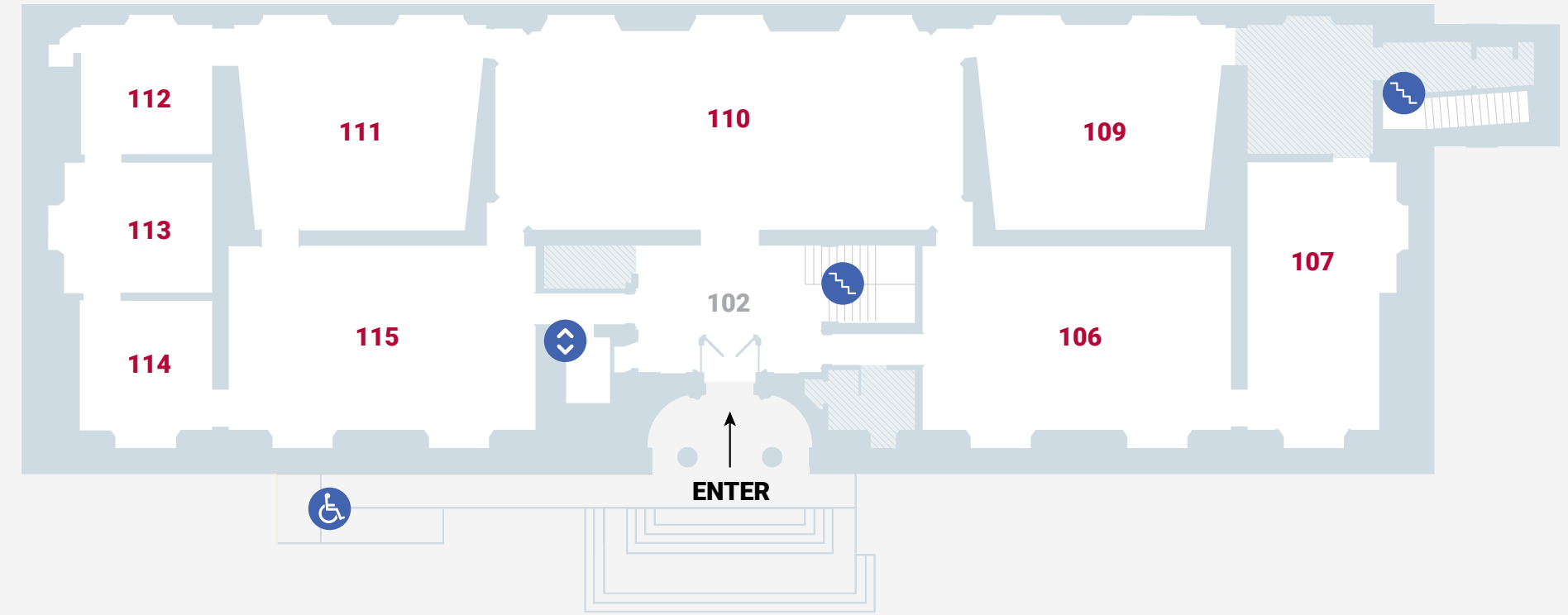

## Second Floor



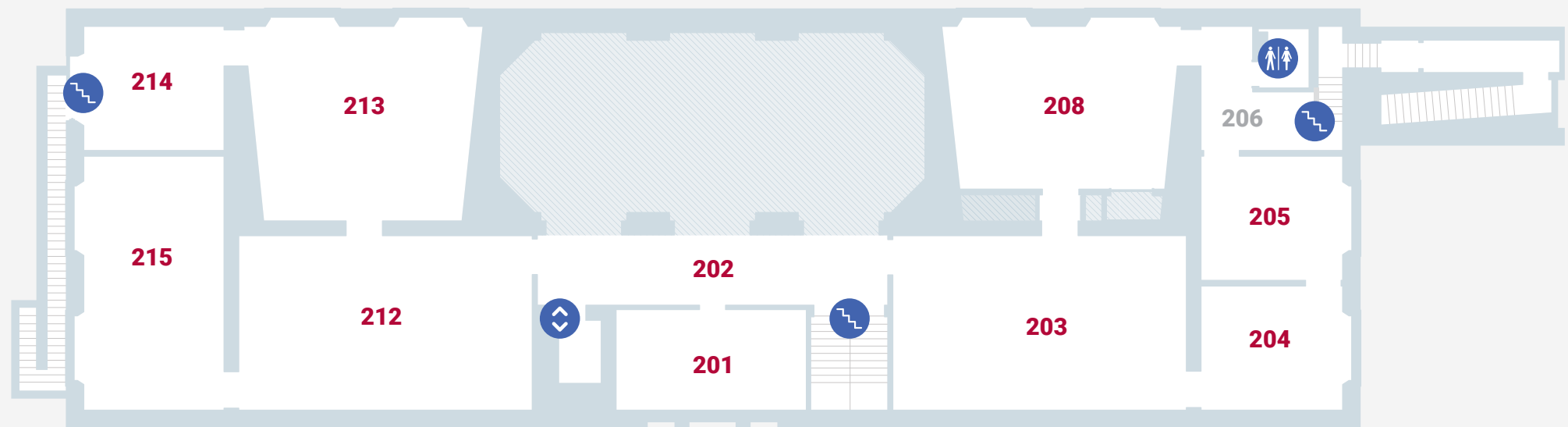

- Rare Books & Works on Paper  
Portraits/Faces  
Metropolitan Museum of Art Cast Collection  
Teaching Gallery  
Critique Space  
Critique Space  
Stained Glass  
20th Century European and American Art  
SJU History  
Wernersville Collection  
Classroom
- 201  
202  
203  
204  
205  
206  
208  
212  
213  
214  
215

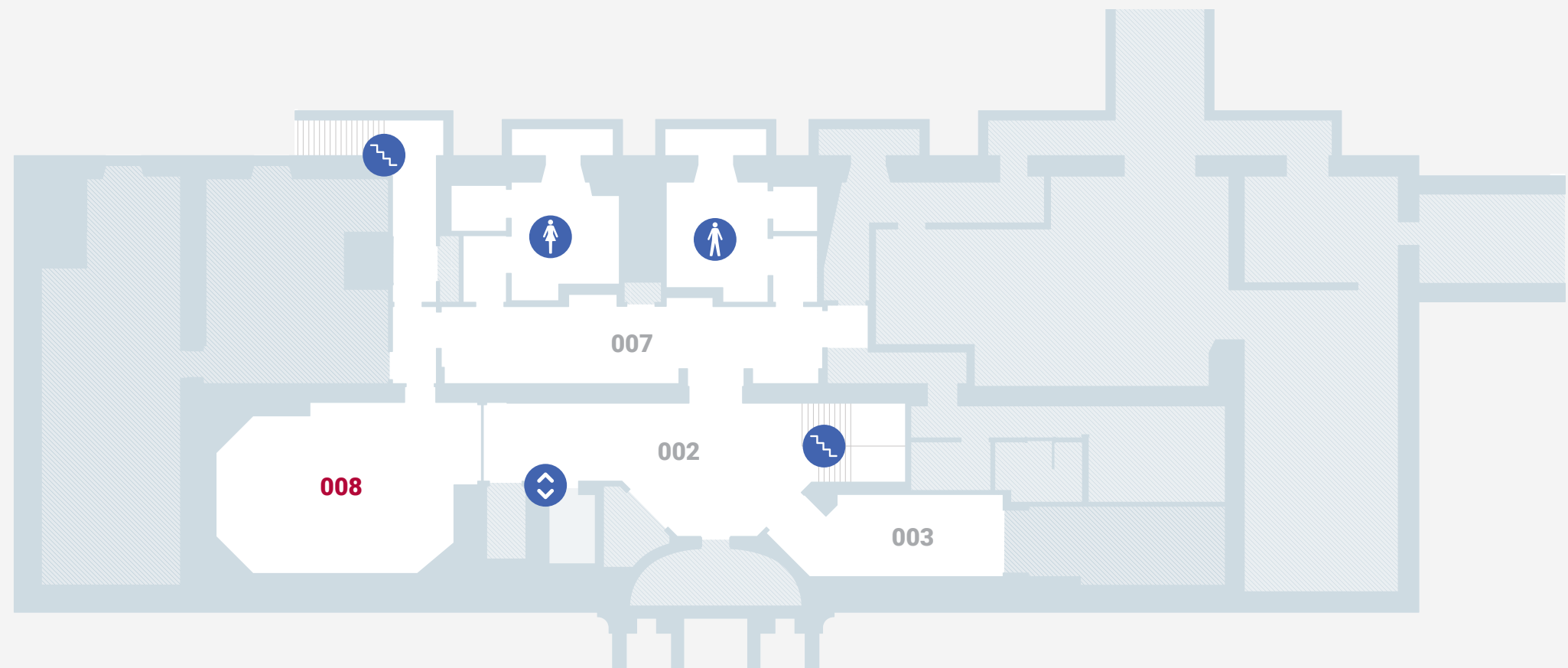

## Lower Level

- Lower Lobby  
Coat Check  
Hallway: Selections from the Permanent Collection  
Creativity Corner
- 002  
003  
007  
008



-  Wheelchair Accessible  
 Stairs  
 Elevator  
 Bathrooms